



PURITY BALL VALVE FOR SEMI- CONDUCTOR AND CHEMOCAL

Application:

The three-piece two-way or three-way design can be used under high pressure. It is also easy to maintain, replace and clean. Ask sales associate for different standard connection ways: such as flange, extended welding type and industrial flange such as JIS, DIN, ANSI, etc.; the surface can also be available for E / P and different Ra requirements.



DIN	ØA	ØB	ØC	ISO	ØA	ØB	ØC	D	(H)	L	L1	(W)
DN10	10	13	34	DN8	10.3	13.5	34	5	58.3	89	135	130
DN15	16	19	34	DN10	14	17.2	34	5	62.9	101	135	130
DN20	20	23	34	DN15	18.1	21.3	34	6.5	66.8	113.8	164.8	166.7
DN25	26	29	50.5	DN20	23.7	26.9	50.5	6.5	66.8	113.8	164.8	166.7
DN32	32	35	50.5	DN25	30.5	33.7	50.5	8.5	86.8	140	165	192.5
DN40	38	41	50.5	DN32	39.2	42.4	50.5	8.5	86.8	140	165	192.5
DN50	50	53	64	DN40	45.1	48.3	64	8.5	94.5	157.3	190	192.5
DN65	66	70	91	DN50	57.1	60.3	77.5	12	126.75	197	205	254
DN80	81	85	106	DN65	72.9	76.2	91	12	135	229	264.5	254
				DN80	85.7	88.9	106					
DN100	100	104	119	DN100	111.1	114.3	130	16	155.5	243.4	305.9	335

PARTS LIST			
Item	Parts name	QTY	Material
1	Body	1	ASTM-A351-CF8M
2	Cap	2	ASTM-A351-CF8M
3	Ball	1	A351-CF8M
4	Seat	2	PTFE
5	Gasket	2	PTFE
6	Stem	1	AISI 316
7	Thrust washer	1	PTFE
8	Stem packing	1	PTFE
9	Bolt	4	AISI 304
10	HEX. Nut	4	AISI 304
11	Spring washer	5	AISI 304
12	Gland	1	AISI 304
13	Nut	1	AISI 304
14	Handle	1	AISI 304
15	Plastic cover	1	plastic
16	Lock device	1	AISI 304
17	Stop pin	1	AISI 304

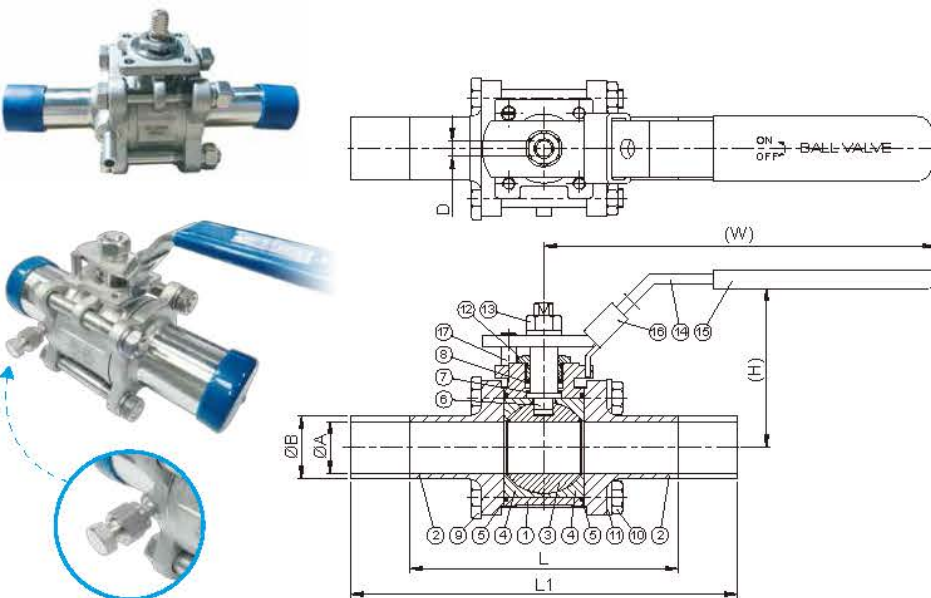

SIZE	ØA (Sch.10)	ØA (Sch.40)	ØB	D	(H)	L	L1	(W)
15A	17.12	15.8	21.34	5	58.3	89	135	130
20A	22.45	20.93	26.67	5	62.9	101	135	130
25A	27.86	26.64	33.4	6.5	66.8	113.8	164.8	166.7
40A	42.72	40.89	48.26	8.5	86.8	140	165	192.5
50A	54.79	52.5	60.33	8.5	94.5	157.3	190	192.5
65A	66.93	62.71	73.03	12	126.75	197	205	254
80A	82.8	77.93	88.9	12	135	229	264.5	254
100A	108.2	102.26	114.3	16	155.5	243.4	305.9	335

PURITY BALL VALVE FOR SEMI- CONDUCTOR AND CHEMOCAL

Purity Flow Control Ball Valve

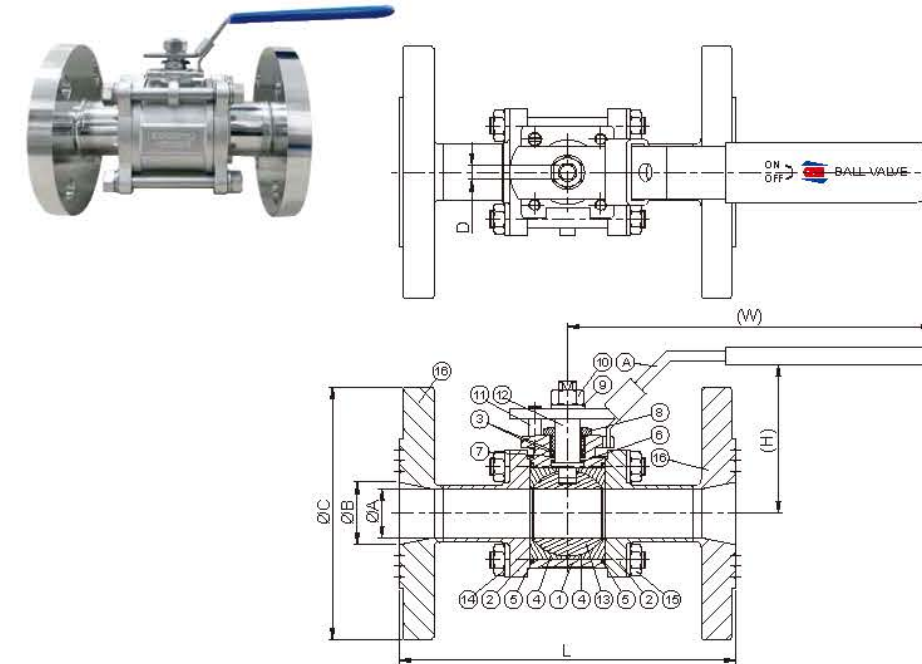

PARTS LIST			
Item	Parts name	QTY	Material
A	Handle	1	AISI 304
1	Body	1	CF3M AISI 316L
2	Cap	2	CF3M AISI 316L
3	Spring washers	2	AISI 304
4	Seat sealing ring	2	PTFE, FDA complinat
5	Flange sealing ring	2	PTFE, FDA complinat
6	Conical spindle seal	1	PTFE, FDA complinat
7	V-Ring spindle packing	1	PTFE, FDA complinat
8	Gland	1	AISI 304
9	Washer	1	AISI 304
10	Upper spindle nut	1	AISI 304
11	stop pin	1	AISI 304
12	Spindel (Stem)	1	AISI 316L
13	Ball	1	CF3M AISI 316L
14	Bolt	4	AISI 304
15	Nut	8	AISI 304
16	Flange	2	AISI 316L
-	Antistatic device	2	AISI 316

Option

other connection can be provided:
JIS 10K, KF, PN16, ANSI, other flanged type, etc...

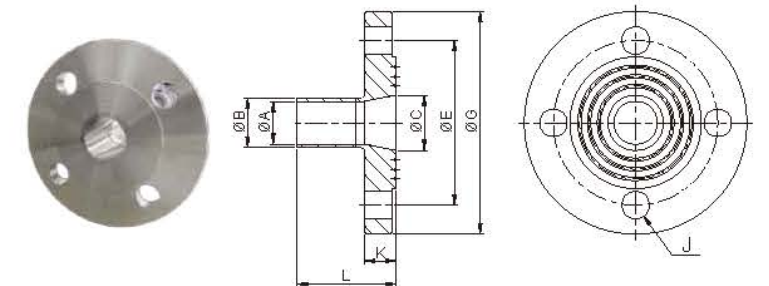

Application:

High purity industries, Semiconductors and pharmaceutical fields

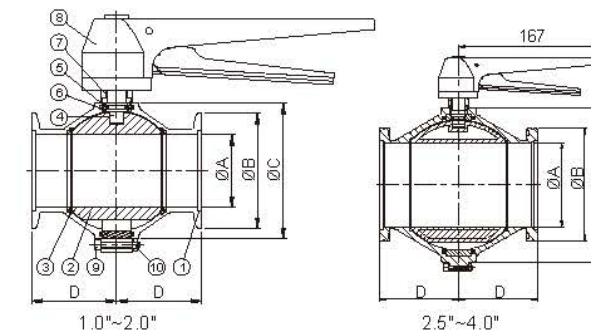

SIZE	øA	øB	øC	D
KF25	22.1	40.01	100	45
KF40	34.8	54.86	105	55
KF50	47.5	74.93	105	55
ISO63	60.2	95	145	65
ISO80	72.9	110.01	159	79
ISO100	97.4	130	198	91

PARTS LIST			
Item	Parts name	QTY	Material
1	Body	2	ASTM-A351-CF8M
2	Ball	1	A351-CF8M
3	O-Ring	2	NBR
4	Stem	1	AISI 316
5	O-Ring	1	NBR
6	O-Ring	1	NBR
7	Sleeve	1	PEEK
8	Handle	1	AISI 304/plastic
9	Bolt	4	AISI 304
10	Nut	4	AISI 304

